



EnergyLED

6F.,NO.542-4,Zhongzheng Rd ., Xindian Dist.,
,New Taipei City 231,Taiwan (R.O.C)
TEL : 886-2-7729-0589
FAX : 886-2-7729-1871
<http://www.energyled.com>

SPECIFICATION

PART NO. : BAxxxHHWW15xx

五代天井燈

High Bay Light

(PRELIMINARY)

Approved by

Checked by

Prepared by

Carlos Chen



Part Number Information : (BAxxxHHWWx5xx)

Part Number Information: (BAxxxHHWW15xx)

BA XX X HHWW 1 5 XX

50=>50W

C=6500K

serial number

0D=>100W

L=5700K

0B=>150W

T=4000K

0C=>200W

W=3000K

Dimensions(尺寸) :

50W and 100W and 150W and 200W :

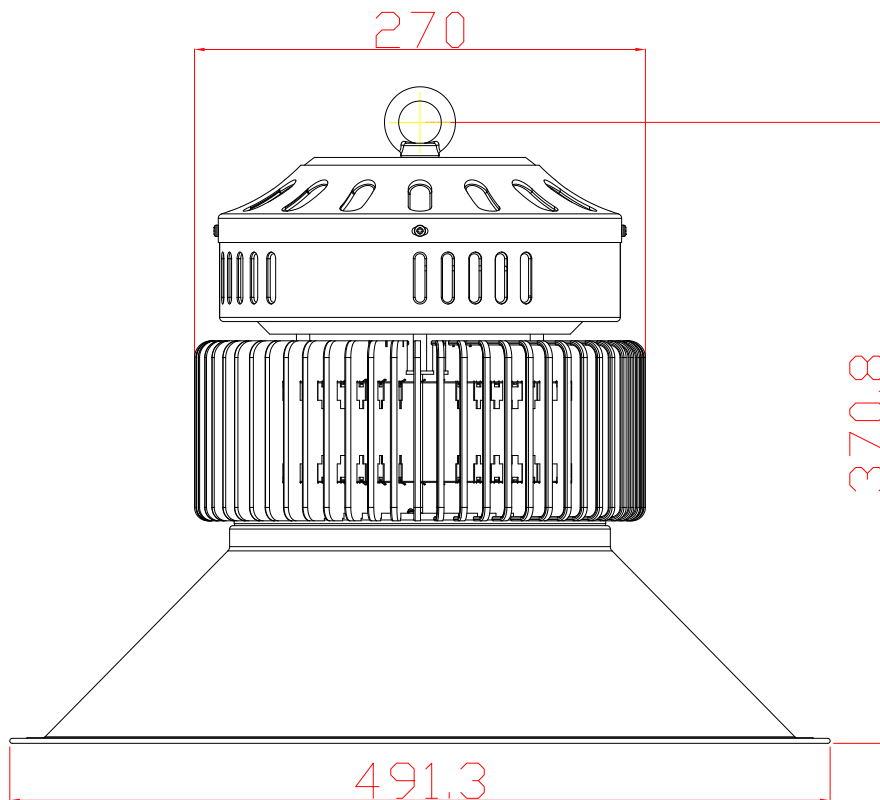

1. All dimensions are in millimeters.
2. Tolerance is ± 2 mm unless otherwise noted.

**Description**

Part No.	Emitting Color	CCT	Operation Voltage
BAxxxHHWW15xx	White	6500K	220 VAC
		5700K	
		4000K	
		3000K	

Absolute Maximum Ratings at Ta=25 °C

Parameter	Symbol	Rating	Unit
Operating Temperature Range	Topr.	-20 to +50	°C
Storage Temperature Range	Tstg.	-20 to +60	°C
Electric Static Discharge Threshold (HBM)	ESD	1000	V
Operating Humidity (non – condensing)	%	60	RH

**Electrical And Optical Characteristics(光電特性):****BA50CHHWW1501 Series (50W CCT=6500K) :**

PART NO. : BA50CHHWW1501	Symbol	Condition	Min.	Typ.	Max.	Unit
Parameter						
Luminous Flux	Φ_v	220 VAC	6750	7500	---	lm
Correlated Color Temperature	CCT	220 VAC	--	6500	--	K
Color Index	%	220 VAC	80	-	-	Ra
Power Consumption	Pd	220 VAC	--	50	--	W
Power Factor		220 VAC	0.92	0.95	--	
Finished weight			--	4.7	--	kg

BA50LHHWW1501 Series (50W CCT=5700K) :

PART NO. : BA50LHHWW1501	Symbol	Condition	Min.	Typ.	Max.	Unit
Parameter						
Luminous Flux	Φ_v	220 VAC	6750	7500	---	lm
Correlated Color Temperature	CCT	220 VAC	--	5700	--	K
Color Index	%	220 VAC	80	-	-	Ra
Power Consumption	Pd	220 VAC	--	50	--	W
Power Factor		220 VAC	0.92	0.95	--	
Finished weight			--	4.7	--	kg

**BA50THHWW1501 Series (50W CCT=4000K) :**

PART NO. : BA50THHWW1501	Symbol	Condition	Min.	Typ.	Max.	Unit
Parameter						
Luminous Flux	Φ_v	220 VAC	6400	7150	---	lm
Correlated Color Temperature	CCT	220 VAC	--	4000	--	K
Color Index	%	220 VAC	80	-	-	Ra
Power Consumption	P _D	220 VAC	--	50	--	W
Power Factor		220 VAC	0.92	0.95	--	
Finished weight			--	4.7	--	kg

BA50WHHWW1501 Series (50W CCT=3000K) :

PART NO. : BA50WHHWW1501	Symbol	Condition	Min.	Typ.	Max.	Unit
Parameter						
Luminous Flux	Φ_v	220 VAC	6400	7100	---	lm
Correlated Color Temperature	CCT	220 VAC	--	3000	--	K
Color Index	%	220 VAC	80	-	-	Ra
Power Consumption	P _D	220 VAC	--	50	--	W
Power Factor		220 VAC	0.92	0.95	--	
Finished weight			--	4.7	--	kg

**BA0DCHHWW1501 Series (100W CCT=6500K) :**

PART NO. : BA0DCHHWW1501	Symbol	Condition	Min.	Typ.	Max.	Unit
Parameter						
Luminous Flux	Φ_v	220 VAC	13500	15000	---	lm
Correlated Color Temperature	CCT	220 VAC	--	6500	--	K
Color Index	%	220 VAC	80	-	-	Ra
Power Consumption	P _D	220 VAC	--	100	--	W
Power Factor		220 VAC	0.92	0.95	--	
Finished weight			--	4.8	--	kg

BA0DLHWW1501 Series (100W CCT=5700K) :

PART NO. : BA0DLHWW1501	Symbol	Condition	Min.	Typ.	Max.	Unit
Parameter						
Luminous Flux	Φ_v	220 VAC	13500	15000	---	lm
Correlated Color Temperature	CCT	220 VAC	--	5700	--	K
Color Index	%	220 VAC	80	-	-	Ra
Power Consumption	P _D	220 VAC	--	100	--	W
Power Factor		220 VAC	0.92	0.95	--	
Finished weight			--	4.8	--	kg

**BA0DTHHWW1501 Series (100W CCT=4000K) :**

PART NO. : BA0DTHHWW1501	Symbol	Condition	Min.	Typ.	Max.	Unit
Parameter						
Luminous Flux	Φ_v	220 VAC	13000	14500	---	lm
Correlated Color Temperature	CCT	220 VAC	--	4000	--	K
Color Index	%	220 VAC	80	-	-	Ra
Power Consumption	P _D	220 VAC	--	100	--	W
Power Factor		220 VAC	0.92	0.95	--	
Finished weight			--	4.8	--	kg

BA0DWHHWW1501 Series (100W CCT=3000K) :

PART NO. : BA0DWHHWW1501	Symbol	Condition	Min.	Typ.	Max.	Unit
Parameter						
Luminous Flux	Φ_v	220 VAC	12500	14000	---	lm
Correlated Color Temperature	CCT	220 VAC	--	3000	--	K
Color Index	%	220 VAC	80	-	-	Ra
Power Consumption	P _D	220 VAC	--	100	--	W
Power Factor		220 VAC	0.92	0.95	--	
Finished weight			--	4.8	--	kg

**BA0BCHHWW1501 Series (150W CCT=6500K) :**

PART NO. : BA0BCHHWW1501	Symbol	Condition	Min.	Typ.	Max.	Unit
Parameter						
Luminous Flux	Φ_v	220 VAC	20000	22500	---	lm
Correlated Color Temperature	CCT	220 VAC	--	6500	--	K
Color Index	%	220 VAC	80	-	-	Ra
Power Consumption	P _D	220 VAC	--	150	--	W
Power Factor		220 VAC	0.92	0.95	--	
Finished weight			--	4.9	--	kg

BA0BLHHWW1501 Series (150W CCT=5700K) :

PART NO. : BA0BLHHWW1501	Symbol	Condition	Min.	Typ.	Max.	Unit
Parameter						
Luminous Flux	Φ_v	220 VAC	20000	22500	---	lm
Correlated Color Temperature	CCT	220 VAC	--	5700	--	K
Color Index	%	220 VAC	80	-	-	Ra
Power Consumption	P _D	220 VAC	--	150	--	W
Power Factor		220 VAC	0.92	0.95	--	
Finished weight			--	4.9	--	kg

**BA0BTHHWW1501 Series (150W CCT=4000K) :**

PART NO. : BA0BTHHWW1501	Symbol	Condition	Min.	Typ.	Max.	Unit
Parameter						
Luminous Flux	Φ_v	220 VAC	19500	22000	---	lm
Correlated Color Temperature	CCT	220 VAC	--	4000	--	K
Color Index	%	220 VAC	80	-	-	Ra
Power Consumption	P _D	220 VAC	--	150	--	W
Power Factor		220 VAC	0.92	0.95	--	
Finished weight			--	4.9	--	kg

BA0BWHHWW1501 Series (150W CCT=3000K) :

PART NO. : BA0BWHHWW1501	Symbol	Condition	Min.	Typ.	Max.	Unit
Parameter						
Luminous Flux	Φ_v	220 VAC	19000	21500	---	lm
Correlated Color Temperature	CCT	220 VAC	--	3000	--	K
Color Index	%	220 VAC	80	-	-	Ra
Power Consumption	P _D	220 VAC	--	150	--	W
Power Factor		220 VAC	0.92	0.95	--	
Finished weight			--	4.9	--	kg

**BA0CCHHWW1501 Series (200W CCT=6500K) :**

PART NO. : BA0CCHHWW1501	Symbol	Condition	Min.	Typ.	Max.	Unit
Parameter						
Luminous Flux	Φ_v	220 VAC	27000	30000	---	lm
Correlated Color Temperature	CCT	220 VAC	--	6500	--	K
Color Index	%	220 VAC	80	-	-	Ra
Power Consumption	P _D	220 VAC	--	200	--	W
Power Factor		220 VAC	0.92	0.95	--	
Finished weight			--	5	--	kg

BA0CLHHWW1501 Series (200W CCT=5700K) :

PART NO. : BA0CLHHWW1501	Symbol	Condition	Min.	Typ.	Max.	Unit
Parameter						
Luminous Flux	Φ_v	220 VAC	27000	30000	---	lm
Correlated Color Temperature	CCT	220 VAC	--	5700	--	K
Color Index	%	220 VAC	80	-	-	Ra
Power Consumption	P _D	220 VAC	--	200	--	W
Power Factor		220 VAC	0.92	0.95	--	
Finished weight			--	5	--	kg

**BA0CTHHWW1501 Series (200W CCT=4000K) :**

PART NO. : BA0CTHHWW1501	Symbol	Condition	Min.	Typ.	Max.	Unit
Parameter						
Luminous Flux	Φ_v	220 VAC	26000	29000	---	lm
Correlated Color Temperature	CCT	220 VAC	--	4000	--	K
Color Index	%	220 VAC	80	-	-	Ra
Power Consumption	P _D	220 VAC	--	200	--	W
Power Factor		220 VAC	0.92	0.95	--	
Finished weight			--	5	--	kg

BA0CWHHWW1501 Series (200W CCT=3000K) :

PART NO. : BA0CWHHWW1501	Symbol	Condition	Min.	Typ.	Max.	Unit
Parameter						
Luminous Flux	Φ_v	220 VAC	26000	28500	---	lm
Correlated Color Temperature	CCT	220 VAC	--	3000	--	K
Color Index	%	220 VAC	80	-	-	Ra
Power Consumption	P _D	220 VAC	--	200	--	W
Power Factor		220 VAC	0.92	0.95	--	
Finished weight			--	5	--	kg



Packing method

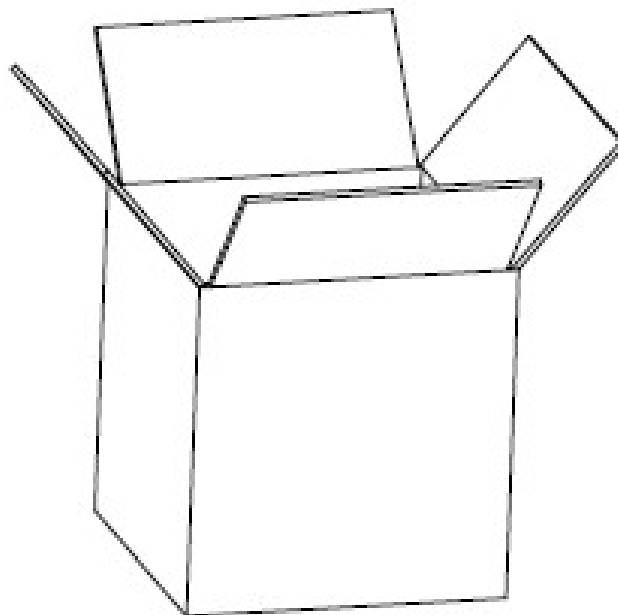
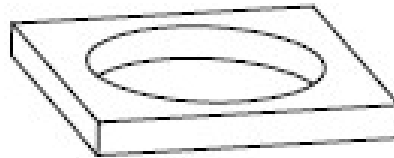
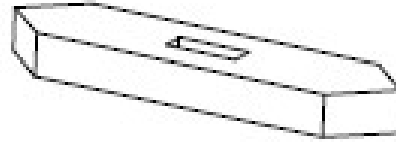

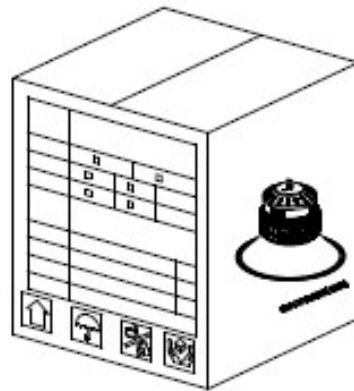
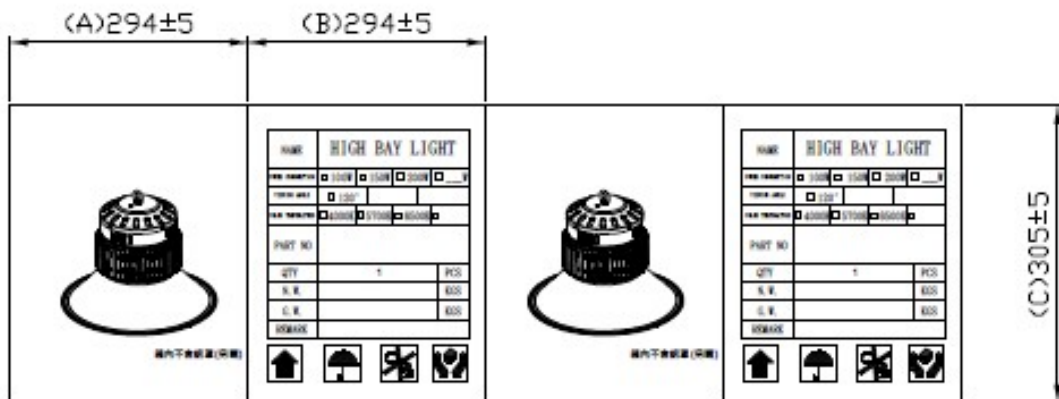

Part No.	A (mm)	B (mm)	C (mm)
BAxxxGHWWx401	294	294	276